

BUCKINGHAM MFG.

PN 483M – BuckSqueeze Rescue Trainer (Fig. 1a)

PN 488P – SuperSqueeze Rescue Trainer (Fig. 1b)

Instructions / Warnings

These devices (Fig. 1a & 1b) are intended for Rescue Training only. They are **not** intended for human support. These devices are only to be used on the Buckingham Rescue Buck PN 694 (Fig. 2) or similar devices, never on a human.

Read and understand these instructions, warnings and all labels attached to and packed with this product. 483 Series BuckSqueeze or 488 Series SuperSqueeze instructions must be used in conjunction with the

instructions outlined below. If a copy is required, you may obtain one from the Buckingham website (www.buckinghammfg.com) or by contacting Buckingham Customer Service at 1-800-937-2825.



**PN 483M
BuckSqueeze
Rescue Trainer
Fig. 1a**



**PN 488P
SuperSqueeze
Rescue Trainer
Fig. 1b**

ATTACHMENT:

1. Attach a suitable linemen's body belt to the Rescue Buck.
2. Attach the Rescue Trainer to the body belt D-rings by means of locking snaphooks.
3. Raise the Rescue Buck to the desired height.
4. Attach the Rescue Trainer to the pole.
5. Properly adjust the Rescue Trainer.

RESCUE:

1. Ensure the area on the ground below the suspended Rescue Buck is cleared and secured (Never stand under a suspended object).
2. Properly attach a secondary suspension device and or lowering device to the Rescue Buck. Ensure all slack is removed from the secondary suspension device.
3. Cut the **Orange strap only** (PN 483A) on the Rescue Trainer (see Fig. 3) NOTE: Cut Replacement Strap at centerline between buckle holes as shown in Fig 4. There must be a minimum of 1" of material from the edge of hole to end of strap.
4. Lower the Rescue Buck to the ground and resume training exercise.

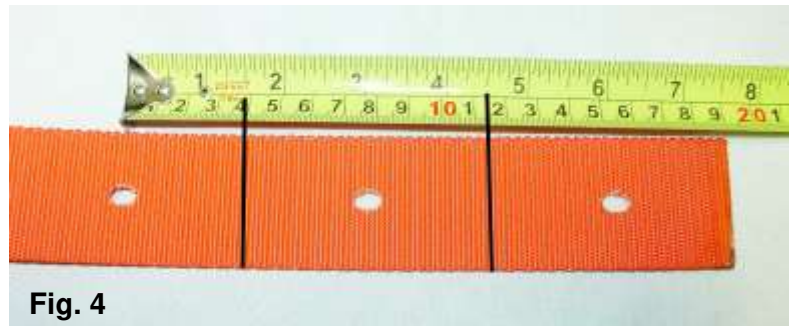

Fig. 2

Fig. 3



Fig. 4



REPLACEMENT STRAP CHANGE OUT: (Replacement Web for Use With This Product Must Only Be That Supplied By Buckingham Mfg. Co. Use PN 488A series only).

- When training is complete (strap has been cut) remove the orange strap by detaching the tongue buckles at each end of the strap and removing the cut orange web from the outer strap components.
- Thread the replacement strap as follows:
PN 483M BuckSqueeze Rescue Trainer - Ensure the orange replacement strap is through the Channel Handle / Cam Assembly (under the Cam) and through the stirrup of the Serrated Rotosnap.
PN 488P SuperSqueeze Rescue Trainer - Ensure orange replacement strap is through the D-ring of the outer strap and through the stirrup of the Serrated Rotosnap.
- Attach the new orange replacement strap by fastening the tongue buckles at each end of the strap (Ref. Fig. 1a & 1b).

WARNINGS:

- Completely read, understand, and follow all instructions, warnings, and guidelines pertaining to this and all associated equipment before use. Failure to do so could result in serious injury or death.
- This equipment is intended for use by properly trained professionals only.
- It is the users responsibility to ensure that they are properly trained in the use, care and limitations of this product.
- This device is intended to be used for training only. It is not intended for any other purpose.
- Never disconnect hardware while suspended without a secondary means of support.
- Prior to use visually check the Orange straps (PN 483A) to ensure they are free from cuts from previous trainings.
- Ensure the ground below the area of intended rescue training is clear and secured.
- Only Buckingham Mfg. Co. or those people authorized in writing by Buckingham Mfg. may make repairs to this equipment.
- Product covered under these instructions / warnings should not be resold / redistributed or re-used after use by original user.

INSPECTION : Inspect prior to each use, inspection should include but not be limited to the following:

1. All hardware and connecting devices are clean and functioning properly, are free of cracks, deformation, burrs, excessive wear, or modifications. Also that:
 - Snaphooks: see Locking Snaphook Inspection Procedure (located on the last page of this document).
 - BuckSqueeze Rescue Trainer: Roller of Paddle Handle / Cam Assembly is securely fastened but freely rotates, all nyloc nuts are in place and securely tightened and frame is not bent or bowed (See photo right).

Cam Buckle / WebGrab locks so that there is no slippage when the Outer Strap (brown neoprene impregnated nylon) is pulled in the direction away from the Paddle. Ensure the knurling of the Cam Buckle is not worn and that the Cam Buckle can not rotate more than 30° if pushed upwards towards the Paddle.

 - SuperSqueeze Rescue Trainer : Cam of the WebGrab rotates freely and locks on the strap when the SuperSqueeze Rescue Trainer is properly adjusted on the pole and weight is placed on the unit.
 - Metal Strap End Clip Rivets are properly peened and tight and hardware is secured to the strap.
2. All straps are free from kinks, knots, cuts, cracks, burns, abrasions, broken strands, excessive wear and chemical exposure.
3. Both the Inner and Outer Straps are not worn to the point of showing the red warning center.



Remove from service, destroy and discard unit if it does not pass this inspection and replace immediately.

CLEANING:

Proper maintenance and storage of your equipment will prolong its useful life and contribute toward its performance. The Training Rescue Device should be cleaned with water and mild soap (a dish washing soap that removes grease (i.e. Dawn)) and be allowed to dry thoroughly without using excessive heat.

NOTE: This product can not be returned unless it is in new / unused condition.

BUCKINGHAM MFG. CO., INC.
BINGHAMTON, NY
1-800-937-2825
www.buckinghammfg.com

LOCKING SNAPHOOK INSPECTION PROCEDURE

- THOROUGHLY INSPECT EACH SNAPHOOK BEFORE EACH USE TO ENSURE:
 - > Rivets are not loose and have adequate head on both sides.
 - > Snaphook is not cracked, corroded or distorted so that the keeper does not properly seat in the bill.
 - > Keeper is not bent or distorted such that it does not properly seat in the bill without binding.
 - > Keeper and lock mechanism are free of burrs.
 - > Keeper and lock mechanism and rivet attachment points are properly lubricated.
 - > Keeper extends into the bill, 3/16" min. (Fig. 5)
 - > Keeper and lock mechanism springs are properly seated and aligned.
 - > Roller turns freely and is not distorted.
- LUBRICATE lock mechanism and keeper on both sides AT LEAST WEEKLY or AS OFTEN AS REQUIRED to maintain smooth operation (no binding) with light weight lubricant such as WD-40®.
- LOCKING SNAPHOOKS FEATURE A SELF-CLOSING, SELF-LOCKING MECHANISM WHICH REMAINS CLOSED UNTIL UNLOCKED AND PRESSED OPEN FOR CONNECTION OR DISCONNECTION.
 - > When the lock mechanism is not activated, the keeper should remain securely locked when depressed.
 - > Depress the lock mechanism. It should move downward easily and spring back to its original position without binding or sticking (Fig. 6).

3/16" MIN.

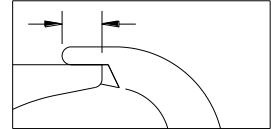

Fig. 5

>Depress the keeper and lock mechanism simultaneously, (Fig. 7), checking for:

- >> ease of movement — no binding
- >> keeper unlocks completely
- >> keeper opens completely, moves through its full range of motion smoothly, and returns to its original position within the bill.

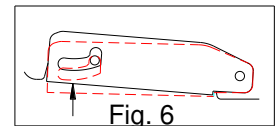

Fig. 6

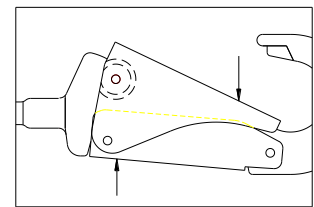
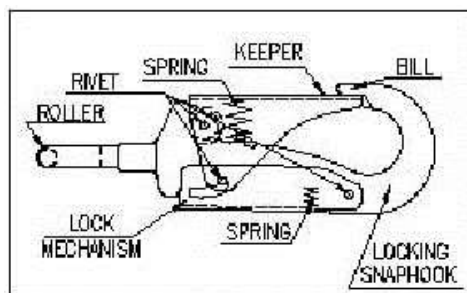
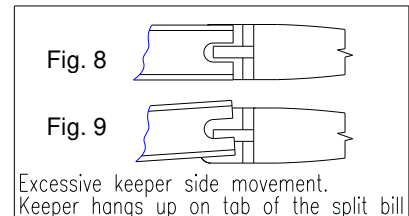

Fig. 7

> Move the keeper side to side to check for excessive side movement (Fig. 8).
Side movement is excessive if the keeper hangs up on the tab of the split bill (Fig. 9)

- **NOTE:** MISUSE / ABUSE OF THIS PRODUCT COULD LEAD TO IMPROPER FUNCTIONING WITH RISK OF INJURY !!! NEVER ATTEMPT TO ALTER OR MODIFY A SNAPHOOK TO BYPASS THE LOCK MECHANISM !!!



**LOCKING POSITIONING STRAP SNAPHOOK
(PATENTED)**

**BUCKINGHAM MFG.
BINGHAMTON, NY
1-800-937-2825**